

CAP 16

è - living inside

è - living outside

Apparecchi ad incasso a parete per illuminazione indiretta da 1, 2 e 3 led, 1 e 2 watt. Sono adatti ad applicazioni su scalinate, pareti esterne, passaggi pedonali, marciapiedi.

Light recessed in the wall for indirect lighting with 1, 2 and 3 leds, 1 and 2 watt. They are suitable for applications on staircases, outdoor walls, pedestrian walkways, pavements.

Appareils muraux encastrés produisant un éclairage indirect à 1, 2 ou 3 leds, 1 et 2 watts. À appliquer sur des escaliers, des parois extérieures, des passages pour piétons, des trottoirs.

Aparatos empotrados en la pared para la iluminación indirecta de 1, 2 y 3 leds, 1 y 2 watt. Son aptos para aplicaciones en escaleras, paredes exteriores, pasos peatonales, aceras.

Beleuchtungskörper für den Wandeinbau für indirekte Beleuchtung mit 1, 2 oder 3 led, 1 und 2 Watt. Für die Installation auf Treppen, Außenwänden, Fußgängerübergängen, Gehsteigen.



La disposizione di più luci a incasso lungo la scalinata consente la visibilità del percorso e la valorizzazione dell'ambiente. Drain 3 led 2 Watt / The various recessed lights installed along the staircase light up the way and make the most of the environment. Drain 3 leds 2 watt. / La disposition de plusieurs éléments d'éclairage encastrés le long de l'escalier permettent d'avoir une bonne visibilité du parcours et de valoriser l'ambiance. Drain 3 leds 2 watts / La colocación de más luces empotradas a lo largo de la escalera dan visibilidad al camino y valorizan el ambiente. Drain 3 leds 2 watt / Die Anbringung mehrerer Einbauleuchten entlang der Treppe ermöglicht eine bessere Sicht auf deren Verlauf und eine Aufwertung des Raums. Drain 3 led 2 Watt

Negozió Bilder Mercer Line - Vienna. La disposizione di più luci a incasso lungo la scalinata consentono la visibilità del percorso e la valorizzazione dell'ambiente circostante naturale ed architettonico. Quara 1 led 2 watt Bilder Mercer Line shop - Vienna. The arrangement of several lights recessed down the steps show the way and bring out the best in the natural surroundings and architecture. Quara 1 led 2 watt / Magasin Bilder Mercer Line - Vienne. La présence de plusieurs appareils d'éclairage encastrés le long de l'escalier assure la visibilité du parcours et la mise en valeur du milieu naturel et architectonique environnant. Quara 1 led 2 watt / Tienda Bilder Mercer Line - Viena. La colocación de varias luces empotradas a lo largo de la escalinata permite la valorización del ambiente circostante natural y arquitectónico. Quara 1 led 2 watt / Geschäft Bilder Mercer Line - Wien. Die Anordnung mehrerer Einbauleuchten entlang der Treppe ermöglichen die Ansicht des Verlaufs und die Aufwertung der natürlichen und architektonischen Umgebung. Quara 1 led 2 watt

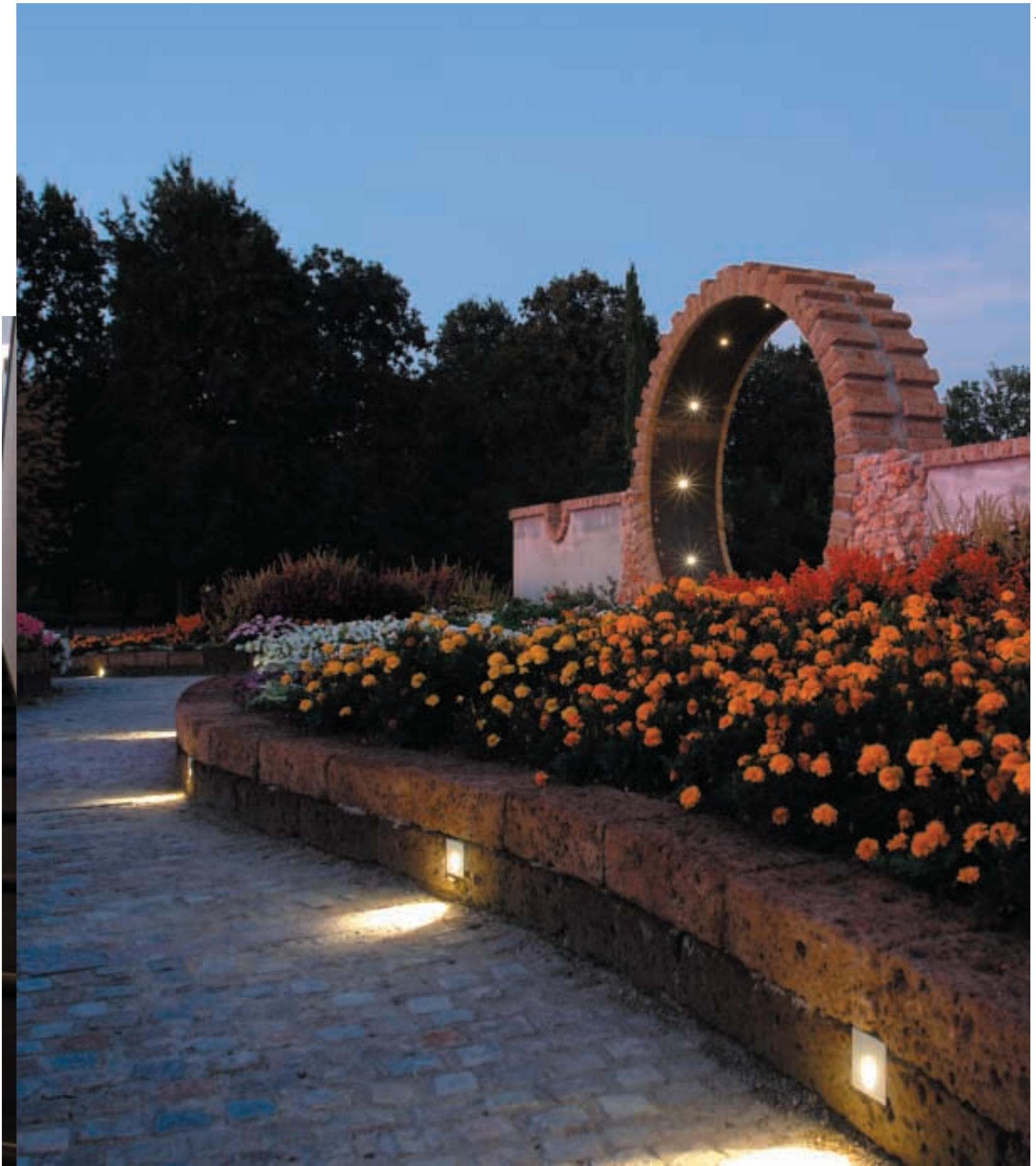

Punti luce asimmetrici non invasivi disegnano armonicamente i viali interni del giardino.

Progetto: Lago dei Salici - Caramagna - Italy
Lighting Design: Fraietta Raffaele
Luci: Manna Giulio;
Verde: Spazio Verde Giardini.

Prodotti: Quara 1 led 2 Watt

Asymmetrical non-obtrusive light points harmonically trace the garden paths.

*Project: "Dei Salici" Lake - Carmagnola - Italy
Lighting Design: Fraietta Raffaele
Lights: Manna Giulio
Garden design: Spazio Verde Giardini.*

Products used: Quara 1 led 2 Watt

Points de lumière asymétriques et discrets traçant harmonieusement les allées internes du jardin.

*Projet: Lac des Saules - Carmagnola - Italie
Design éclairage: Fraietta Raffaele
Éclairage: Manna Giulio
Parc: Spazio Verde Giardini.*

Produits: Quara 1 led 2 Watt

Puntos de luz asimétricos no invasivos dibujan armónicamente los senderos en el jardín.

*Proyecto: Lago de los sauces - Carmagnola - Italia
Lighting Design: Fraietta Raffaele
Luces: Manna Giulio
verde: Spazio Verde Giardini.*

Productos: Quara 1 led 2 Watt

Nicht übergreifende asymmetrische Lichtpunkte zeichnen harmonisch die internen Gartenwege.

*Projekt: Lago dei Salici (Weidensee) - Carmagnola - Italien
Lighting Design: Fraietta Raffaele
Lichtdesign: Manna Giulio
Bepflanzung: Gartenbaubetrieb.*

Produkte: Quara 1 led 2 Watt

INSIDE
OUTSIDE | wall



Drain



Drain

Aplicación empotrable a
iluminación indirecta.
Cuerpo en aluminio,
aplicación con contracaja.

Wandeinbauleuchte
mit indirekter Beleuchtung.
Aluminiumgehäuse,
Anbringung mit
Montagegehäuse.

Apparecchio ad
incasso a parete
ad illuminazione indiretta.
Corpo in alluminio,
applicazione con controcassa.

Wall recessed fixture, indirect light.
Full aluminium,
assembled with outercasing.

Encastré a paroi d'intérieur
avec éclairage indirect.
Corps en Aluminium.
Application avec boîtier d'encastrer.

MULTICHIP
Technology

2 Watt **2 Watt** **1 Watt**
3 LED **1 LED** **1 LED**

G	88397	85780	85772
B	88396	85781	85774

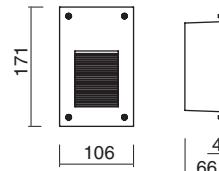

Driver NON compreso

Driver not included
Driver non compris
Driver no incluido
exklusive Driver

vedi cap. Driver
See Driver section
Voir chapitre Drivers
Ver capitolo Driver
siehe Kap. "Driver"



Opticals	code	Colours
----------	------	---------

70°	70	<ul style="list-style-type: none"> ● C ● W ● N ● B ● Y ● R ● G
-----	-----------	---

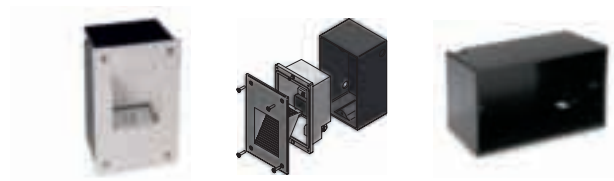

84909
Controcassa
Outercasing
Boîtier
Contracaja
Einbangehäuse



INSIDE
OUTSIDE wall

Drain

Drain

Apparecchio ad incasso a parete ad illuminazione indiretta. Corpo in alluminio, applicazione con controcassa.

Wall recessed fixture, indirect light. Full aluminium, assembled with outercasing.

Encastré a paroi d'intérieur avec éclairage indirect. Corps en Aluminium. Application avec boîtier d'encastrer.

Aplique empotrable a iluminación indirecta. Cuerpo en aluminio, aplicación con contracaja.

Wandeinbauleuchte mit indirekter Beleuchtung. Aluminiumgehäuse, Anbringung mit Montagegehäuse.



Driver compreso

Driver included
Driver compris
Driver incluido
inklusive Driver

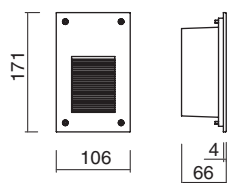

MULTICHIP
Technology

	1 Watt	1 Watt	2 Watt	
	1 LED	3 LED	1 LED	
	85776	88399	85782	G
	85778	88398	85783	B

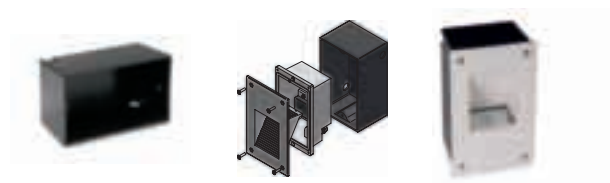

84909
Controcassa
Outercasing
Boitier
Contracaja
Einbangehäuse

Colours	Opticals	code
● C	70°	70
● W		
● N		
● B		
● Y		
● R		
● G		

- living inside



- living outside



INSIDE
OUTSIDE | wall



Invas



Aplicación empotrable oculto a iluminación indirecta.
Cuerpo en aluminio,
aplicación con contracaja.

Versenkbare Einbauleuchte,
indirekte Beleuchtung.
Aluminiumgehäuse,
Anbringung mit
Montagegehäuse.

Invas

Faretto ad incasso
a parete a scomparsa,
illuminazione indiretta.
Corpo in alluminio,
applicazione con
controcassa.

Hiding wall recessed spotlight,
indirect light. Full aluminium,
assembled on outercasing.

Encastré a recouvrement pour
paroi, éclairage indirect.
Corps en Aluminium.
Application avec boîtier
d'encastrer.

1 Watt

1 LED

B

86460

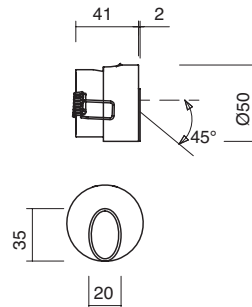

Driver NON compreso

Driver not included
Driver non compris
Driver no incluido
exklusive Driver

vedi cap. Driver
See Driver section
Voir chapitre Drivers
Ver capitolo Driver
siehe Kap. "Driver"

86460N70



Opticals	code	Colours
70°	70	<ul style="list-style-type: none"> ● C ● W ● N ● B ● Y ● R ● G



84338
Controcassa
Outercasing
Boitier
Contracaja
Einbangehäuse

488 | CAP 16



INSIDE
OUTSIDE wall

Quara

Quara

Apparecchio ad incasso a parete ad illuminazione indiretta. Corpo in alluminio, applicazione con controcassa o su cartongesso.

Recessed aluminum spotlight with indirect lighting. Application with outercasing or for plasterboard.

Encastré a paroi d'intérieur avec éclairage indirect. Corps en Aluminium. Application avec boîtier d'encastrer ou pour placoplâtre.

Aplique empotrable a iluminación indirecta. Cuerpo en aluminio, aplicación con contracaja o para cartón piedra.

Wandeinbauleuchte mit indirekter Beleuchtung. Aluminiumgehäuse, Anbringung mit Montagegehäuse oder für Gips.

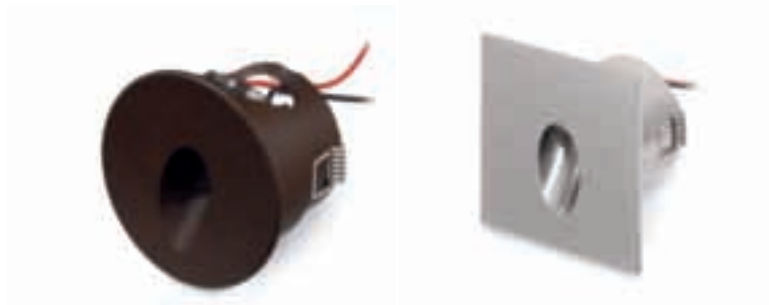

Driver NON compreso

Driver not included
Driver non compris
Driver no incluido
exklusive Driver

vedi cap. Driver
See Driver section
Voir chapitre Drivers
Ver capitolo Driver
siehe Kap. "Driver"

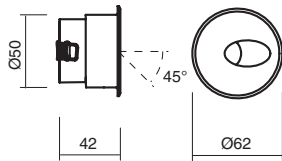

1 Watt 2 Watt

1 LED 1 LED

85540	85542	G
85541	85543	B
86401	86402	N
87986	87988	CT

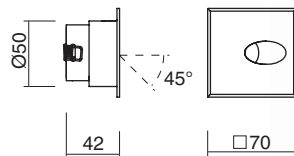

1 Watt 2 Watt

1 LED 1 LED

86559	86562	G
86560	86563	B
86561	86564	N
87987	87989	CT

Ø 52mm



0,170



350mA



600mA



85541N70
85542N70
85542W70
85543N70
86563N70
86564N70
86564W70



Colours

Opticals code

- C
- W
- N
- B
- Y
- R
- G

70° 70



84338

Controcassa
Outercasing
Boîtier
Contracaja
Einbangehäuse



OUTSIDE wall

Gyps

Gyps

Faretto da incasso a parete interamente in alluminio, ottica basculante, montaggio su controcassa.

Wall recessed spotlight, full aluminium, with adjustable optic and outercasing.

Spot à encastrer a paroi entièrement en Aluminium, optique basculante. Montage avec boîtier d'encastrer.

Aplicque empotrable enteramente en aluminio con óptica basculante. Montaje con contracaja.

Wandeinbauleuchte ganz aus Aluminium. Schwingoptik. Montage auf Montagegehäuse.



Driver compreso

Driver included
Driver compris
Driver incluido
inklusive Driver

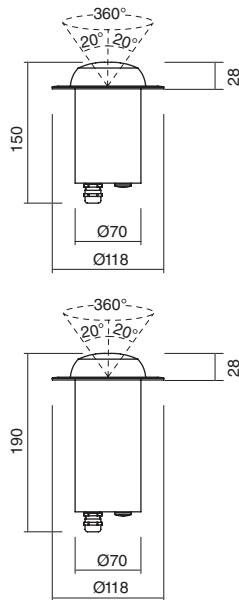

1 Watt

3 LED

85343

G

84341

Controcassa
Outercasing
Boîtier
Contracaja
Einbangehäuse

2 Watt

3 LED

85345

G

84900



Colours Opticals code

- C
- W
- N
- B
- Y
- R
- G

70° 70
120° 12



84341
Controcassa
Outercasing
Boîtier
Contracaja
Einbangehäuse



84900
Controcassa
Outercasing
Boîtier
Contracaja
Einbangehäuse

CAP 16 | 491



Axum



Aplique empotrable enteramente en aluminio con óptica basculante. Montaje con contracaja.

Wandeinbauleuchte ganz aus Aluminium. Schwingoptik. Montage auf Montagegehäuse.

Axum

Faretto da incasso a parete interamente in alluminio, ottica basculante, montaggio su controcassa.

Wall recessed spotlight, full aluminium, with adjustable optic and outercasing.

Encastré a paroi entièrement en Aluminium, optique basculante, montage sur boîtier d'encastrer.

Controcassa
Outercasing
Boîtier
Contracaja
Einbangehäuse

1 Watt

3 LED

84341

G

85354

2 Watt

3 LED

84900

G

85356

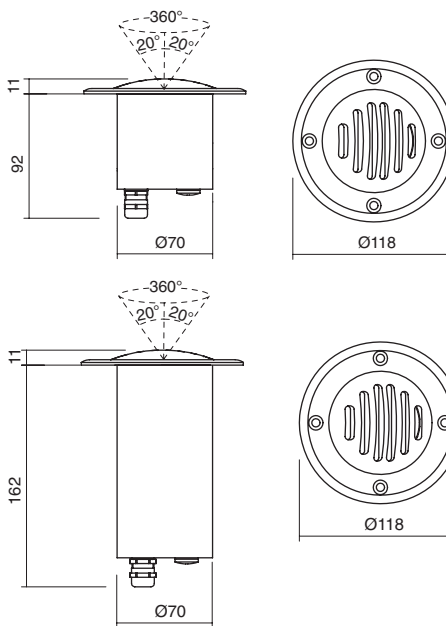

Driver NON compreso

*Driver not included
Driver non compris
Driver no incluido
exklusive Driver*

*vedi cap. Driver
See Driver section
Voir chapitre Drivers
Ver capitolo Driver
siehe Kap. "Driver"*

600 mA 350mA 0,880 1,060

Opticals	code	Colours
70°	70	● C
120°	12	● W
		● N
		● B
		● Y
		● R
		● G



84900
Controcassa
Outercasing
Boîtier
Contracaja
Einbangehäuse



84341
Controcassa
Outercasing
Boîtier
Contracaja
Einbangehäuse



OUTSIDE wall

Axum

Axum

Faretto da incasso a parete interamente in alluminio, ottica basculante, montaggio su controcassa.

Wall recessed spotlight, full aluminium, with adjustable optic and outercasing.

Encastré a paroi entièrement en Aluminium, optique basculante, montage sur boîtier d'encastrer.

Aplique empotrable enteramente en aluminio con óptica basculante. Montaje con contracaja.

Wandeinbauleuchte ganz aus Aluminium. Schwingoptik. Montage auf Montagegehäuse.



Driver compreso

Driver included
Driver compris
Driver incluido
inklusive Driver

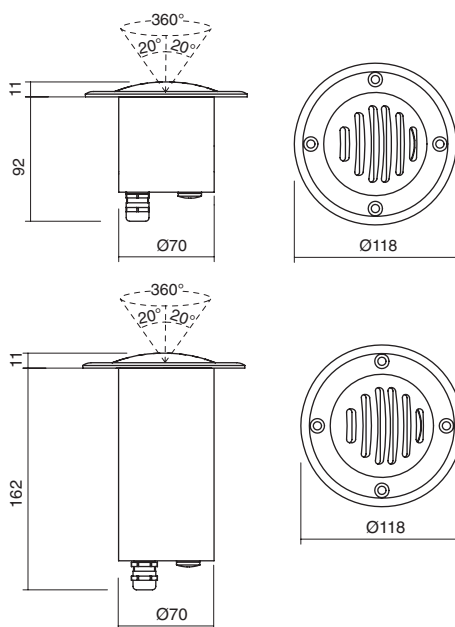

1 Watt

3 LED

85355

G

84341

Controcassa
Outercasing
Boîtier
Contracaja
Einbangehäuse

2 Watt

3 LED

85357

G

84900



Colours

Opticals code

- C
- W
- N
- B
- Y
- R
- G

70° **70**
120° **12**



84341
Controcassa
Outercasing
Boîtier
Contracaja
Einbangehäuse



84900
Controcassa
Outercasing
Boîtier
Contracaja
Einbangehäuse

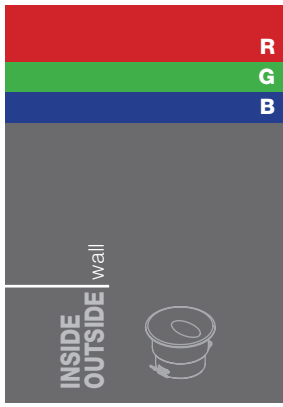

Quara **MULTICHIP**
Technology



Aplicación empotrable a iluminación indirecta.
Cuerpo en aluminio, aplicación con contracaja o para cartón piedra.

Wandeinbauleuchte mit indirekter Beleuchtung.
Aluminiumgehäuse, Anbringung mit Montagegehäuse oder für Gips.

Quara

Apparecchio ad incasso a parete ad illuminazione indiretta.
Corpo in alluminio, applicazione con contracassa o su cartongesso.

Recessed aluminum spotlight with indirect lighting.
Application with outercasing or for plasterboard.

Encastré a paroi d'intérieur avec éclairage indirect.
Corps en Aluminium.
Application avec boîtier d'encastrer ou pour placoplâtre.

1 Watt RGB

3 LED

G	86687
B	86688
N	86689
CT	87990

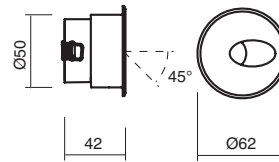

Driver NON compreso

Driver not included
Driver non compris
Driver no incluido
exklusive Driver

vedi cap. Driver RGB
See RGB Driver section
Vedi capitolo RGB Drivers
Ver capitolo Driver RGB
siehe Kap. "RGB Driver"

1 Watt RGB

3 LED

G	86690
B	86691
N	86692
CT	87991

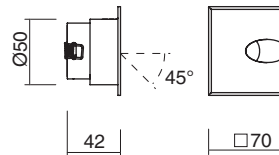

350mA 0,170 0,180

Opticals	code	Colours
70°	70	z



84338
Contracassa
Outercasing
Boitier
Contracaja
Einbangehäuse



L'accoglienza verso una villa di prestigio viene accompagnata dalla giusta luce.

Progetto: Villa privata, Toscana, Italy
Light Design: Zani Ranzenigo

Prodotti: Quara 1 led 2 watt
bianco naturale

A welcoming staircase leading up to a prestigious villa is accompanied by the right lighting.

Project: Private home, Tuscany, Italy
Light Design: Zani Ranzenigo

Products used: Quara 1 led 2 watt
natural white

Un éclairage adéquat pour offrir un accueil digne de cette villa prestigieuse

Projet : Villa privée, Trévis, Italie
Design éclairage : Zani Ranzenigo

Produits: Quara 1 led 2 watts blanc
naturel

La acogida hacia una vivienda de prestigio viene acompañada de la luz ideal.

Proyecto: Chalet particular - Toscana - Italia
Light Design: Zani Ranzenigo

Productos: Quara 1 led 2 watt
blanco natural

Der herzliche Empfang in einer prestigevollen Villa wird durch stimmungsvolles Licht begleitet.

Projekt: Privatvilla, Toscana, Italien
Lighting Design: Zani Ranzenigo

Produkte: Quara 1 led 2 Watt
Neutralweiß